



Cartridge Product Guide

Cartridge Component Breakdown

Disposable, plastic cartridges provide a clean, efficient and a low cost method to meet all types of production requirements. Plungers with a wiper leading edge clean each cartridge thoroughly. Tip and end caps are available making the system ideal for pre-packaged materials as well as pre-mixed and frozen.



End Caps

Used to prevent dust contamination when the cartridge is not in use.



Plungers

Prevents fluid leaking out of nozzle end. Used to ensure even pressure distribution throughout the fluid.

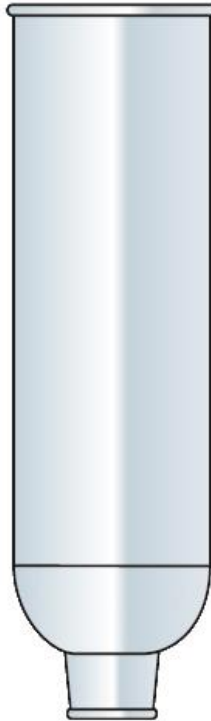

Cartridges

Used when a standard syringe capacity is not large enough.

Features:

Standard and black polyethylene available in all sizes. Low density available in most common cartridge sizes, Industrial standard 1/4 NPT output thread on all sizes, Other color options available, Excellent performance when using premixed or frozen fluids with low density cartridges.



Tip Caps

Used to seal cartridge when not in use.

Cartridges



TS25C-500
TS25C-LD-500
TS25C-GREEN-500

2.5oz/65ml HD
 2.5oz/65ml LD
 2.5oz/65mlHD



TS60C-500
TS60C-LD-500
TS60C-BLACK-500
TS60C-GREEN-500

6oz/165ml HD
 6oz/165ml LD
 6oz/165ml HD
 6oz/165ml HD



TS80C-250
TS80C-LD-250

8oz/240ml HD
 8oz/240ml LD



TS120C-250
TS120C-LD-250
TS120C-BLACK-250
TS120C-GREEN-250

12oz/320ml HD
 12oz/320ml LD
 12oz/320ml HD
 12oz/320ml HD



TS110C-250
TS110C-LD-250
TS110C-BLACK-250

1/10 gallon/310ml HD
 1/10 gallon/310ml LD
 1/10 gallon/310ml HD



TS20C-100
TS20C-BLACK-100

20oz/595ml HD
 20oz/595ml HD

Plungers



TS1P-SR-1000
 Standard LDPE blue wiper plunger. 2.5oz to 12oz



TS1PB-SR-1000
 Standard LDPE black wiper plunger. 2.5oz to 12oz



TS1WP-1000
 Extended LDPE wiper plunger. 2.5oz to 12oz



TS1WP-RIB-1000
 To reduce air entrapment during filling and dispensing. LDPE 2.5oz to 12oz



TS2PW-1000
 1/10 gallon LDPE/EVA standard white wiper plunger



TS2P-BLACK-1000
 1/10 gallon LDPE black wiper plunger



TS20P-100
 20oz standard MDPE wiper plunger



TS20PLD-100
 20oz LDPE wiper plunger

End Caps



TS2C-1000 2.5oz – 12oz end cap
TS4C-1000 1/10 gallon end cap
TS6C-1000 20oz end cap

Tip Caps



TS3P-1000
 Threaded cartridge cap – Tri-seal
 For use on all cartridge sizes



TS4P-1000
 Threaded cartridge cap – square
 For use on all cartridge sizes



TS5P-1000
 Snap on cartridge cap – Tri-Seal
 For use on all cartridge sizes



TS6P-RED-1000
 Threaded cartridge red cap
 For use on all cartridge sizes



TS6P-BLACK-1000
 Threaded cartridge black cap
 For use on all cartridge sizes



TS9X-1000
 Push on cartridge cap
 For use on all cartridge sizes

Cartridge Adaptors



Part Number: **TSD931-15**
 Material: Black Nylon/Celcon
 Thread Size: 1/4" NPT
 Use: Syringe filling



Part Number: **TSD931-7**
 Material: White polypropylene
 Thread Size: 1/4 -18 NPT
 Use: Dispense tip adaptor



Part Number: **TSD931-14**
 Material: Black polypropylene
 Thread Size: 1/4 -18 NPT
 Use: Dispense tip adaptor



Part Number: **TSD918-3**
 Material: Clear Polypropylene
 Use: Male/Female 1/4 -18 NPT

Dispense Nozzles



2.5"/63.5mm length Orifice
TS216-1000 0.063"/1.6mm
TS218-1000 0.125"/3.18mm
TS218-LD-1000 0.125"/3.18mm



4"/101.6mm length
TS416-HO-HD-1000 0.063"/1.6mm
TS416-HO-LD-1000 0.063"/1.6mm
TS418-HO-LD-1000 0.125"/3.18mm
TS432-HO-HD-1000 0.031"/0.79mm
TS432-HO-LD-1000 0.031"/0.79mm
TS490-HO-LD-1000 0.094"/2.39mm



6" length/152.4mm
TS616-HO-LD-1000 0.063"/1.6mm
TS618-HO-LD-1000 0.125"/3.18mm

Speciality



TS1050-1000 A 0.06"/1.52mm
 B 0.5"/12.7mm



TS1050-45-1000 A 0.06"/1.52mm
 B 0.5"/12.7mm



TS1075-1000 A 0.13"/3.30mm
 B 0.75"/19.05mm



TS1100-1000 A 0.13"/3.30mm
 B 1"/25.4mm



TS1175-1000 A 0.13"/3.30mm
 B 1.75"/44.45mm



TS3106-1000 A 0.11"/2.79mm
 B 0.35"/8.89mm
 C 0.06"/1.52mm



TS3206-1000 A 0.11"/2.79mm
 B 0.35"/8.89mm
 C 0.06"/1.52mm

TS Series Retainers

Techcon Systems TS Series aluminium retainers "twist-lock" to their dispensing cap. The retainers are light weight & the durable construction allows up to 100psi (0 to 6.9 bar) applied air pressure.

With visual low level fluid slots



918-030-000 2.5oz/65ml
918-031-000 6oz/165ml
918-034-000 8oz/240ml
918-032-000 12oz/320ml

Without visual low level fluid slots



918-044-000 2.5oz/65ml
918-045-000 6oz/165ml
918-046-000 8oz/240ml
918-047-000 12oz/320ml

TS Retainer Caps

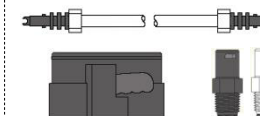

918-001-004 TS Series cap
918-000-002 Air hose assembly
534 Adaptor w/shutoff
534A Adaptor no shutoff

G-Series Retainers – for 1/10 gallon & 20oz. No slot option.



110-2 1/10 gallon/310ml



101-20R* 20oz/595ml

G-Series Retainer Caps

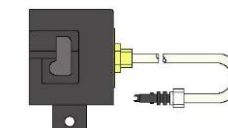

918-000-036 1/10 gallon and 20oz cap

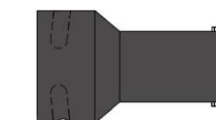

101-20A* 20oz reducer

*For the 20oz retainer (**101-20R**) to fit the cap (**918-000-036**), the reducer (**101-20A**) must be used.